

APARTMENT M29, THE SOANE

SOLE AGENT



1

BEDROOM

1

BATHROOM

547

SQ FT

£1,425 ST. HELIER

ENTITLED/LICENSED. Livingroom is delighted to introduce this luxury apartment situated on the top floor of the new Soane development. The bright and spacious accommodation comprises an open plan kitchen with fitted appliances/sitting room with floor to ceiling windows, double bedroom with fitted wardrobes and bathroom. The property also benefits from a communal landscaped courtyard garden. Lift access. A 20% discount at Carrefour Health Club is offered to all residents. Regrettably no pets. Available in February 2025.



LIVINGROOM

The Channel Island Estate Agent











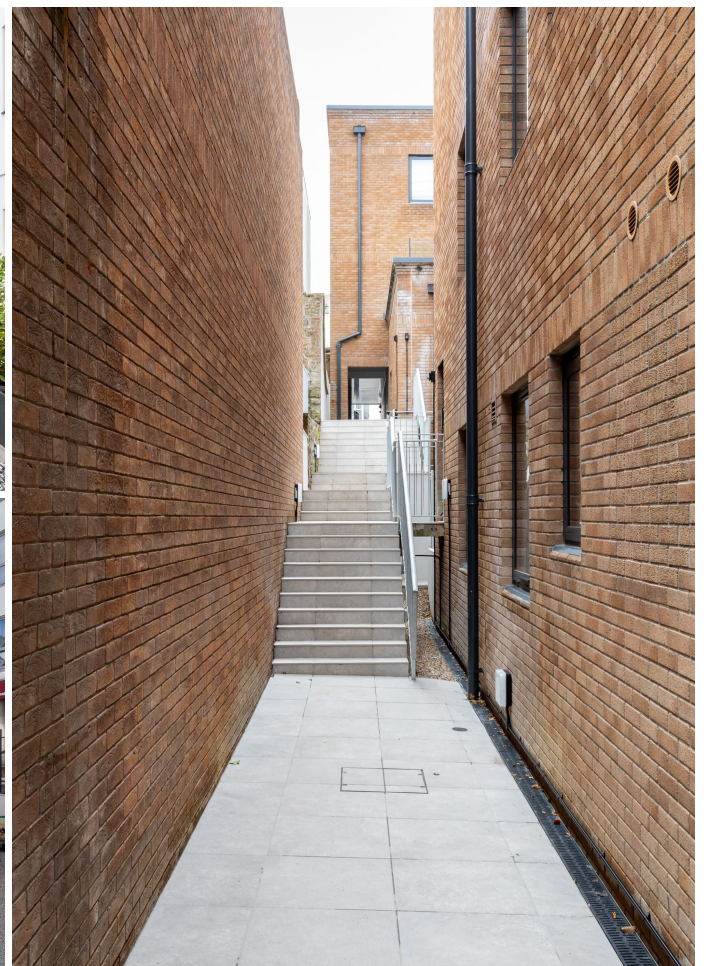

Entrance hall	9'10 x 6'8
Kitchen/sitting room	17'11 x 15'1
Bedroom	15'6 x 13'8
Bathroom	9'6 x 6'8

KEY FACTS

Top floor luxury apartment within The Soane development
Within a short stroll of the town centre
547 sq ft of accommodation
Open plan fully fitted kitchen/sitting room with floor to ceiling windows
Double bedroom with fitted wardrobes
Landscaped communal courtyard gardens
Available in February 2025
ENTITLED/LICENSED

SERVICES

Mains water and drainage

HEATING

Electric heating throughout
Underfloor heating in the bathroom

APPLIANCES

Neff oven, hob and extractor
Neff fridge/freezer
Neff dishwasher
Neff microwave
Candy washer/dryer

OTHER

Fitted with fibre

INCLUSIONS

To include all items listed in the inventory/condition report

These particulars are supplied on the understanding all negotiations by Livingroom are conducted through this office. We understand these particulars to be correct but we do not guarantee their accuracy nor do they form part of any contract. Any floor plans provided are for the purposes of identification only and are not of absolute delineation. Measurements and areas illustrated are approximate and should not be relied upon. Livingroom have not undertaken a detailed survey, nor tested the services, appliances and specific fittings.

£1,425



LIVINGROOM
The Channel Island Estate Agent